

# BR Series Metal Indicator Lights

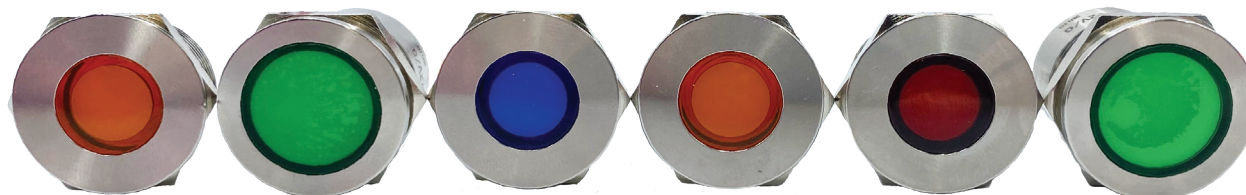

Solico offers a range of BR Series Metal Indicator Lights with 6 / 8 / 10 / 12 / 16 / 19 / 22 mm mounting holes, a variety of voltages, LED color options, and fixed or flashing LEDs.



The BR series is designed to offer an aesthetic quality and polished LED light output for a wide range of applications and markets. The threaded bushing indicator includes a hexagon nut and silicone seal to complement its rear epoxy sealed base. The LED is extremely durable due to its solid-state design and ability to withstand a wide temperature range. Solico LED lights reliably indicate the status of different components, reducing the need for maintenance while saving energy in your application.

## Features include:

- Threaded Metal Housing
- Imprinted Legends
- Voltage Rating: 5VDC - 110VAC
- Corrosion and Impact Resistant
- IP 67 & IP 68, IK10
- Epoxy Sealed terminations
- Multiple display function
- Dual and Tri color options
- LED's fixed and flashing

## BR Series Part Number System

Panel Mounting	Code	Voltage	Code	Termination	Code	Bezel Style	Code	Bezel Finish	Code
06 mm	06	12 VDC	12	Rear Epoxy Wire	1	Flushed	1	Bright Chrome	1
08 mm	08	24 VDC	24	Solder Lug / Fastons (2.8 x 0.8)	5	Recessed	2	Black	2
10 mm	10	125 VAC	15						
12 mm	12								
16 mm	16								
19 mm	19								
22 mm	22								
Lamp	Code	Lens Colors	Code	Lens Marking	Code	Legend Color	Code	4 Digit Numbering	
Fixed	1	Red	1	Not Applicable	0	Not Applicable	0	None	
Flashing	2	Green	4	Legend Imprint	A	White	1	0.0000 (example)	
		Blue	5			Black	2		
		White	6						
		Yellow	8						

## Markets include:

- Transportation
- Emergency Vehicles
- Construction / Agriculture Equipment
- Appliance / Commercial Food
- Vacuums / Floor cleaners
- Vending Machines
- Environmental Controls
- Control Panels
- Factory Automation

# BR Series Indicator Light

Spec sheet  
6 / 8 / 10 / 12 / 16 / 19 / 22 mm

06 mm Panel Mount

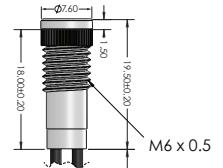
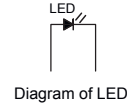
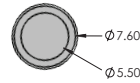

08 mm Panel Mount

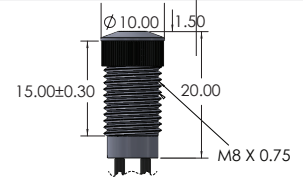
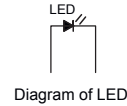
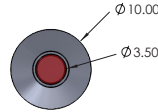

10 mm Panel Mount

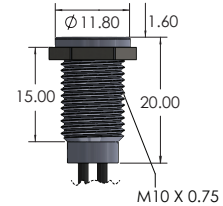
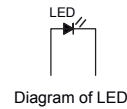
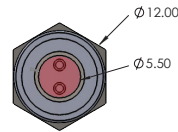

12 mm Panel Mount

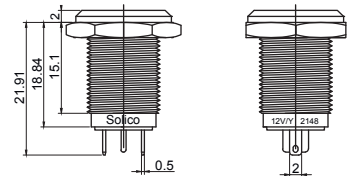
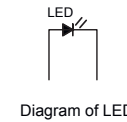
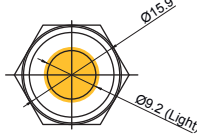

16 mm Panel Mount

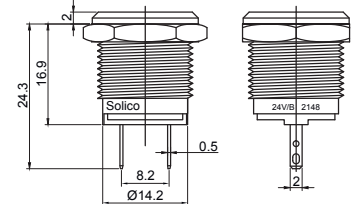
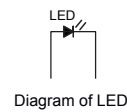
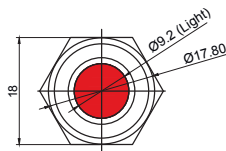
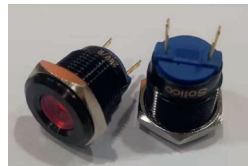

19 mm Panel Mount

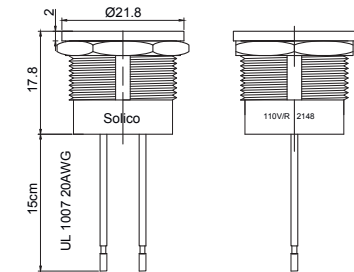
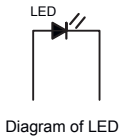
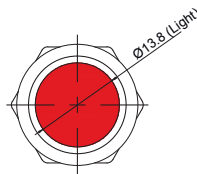

22 mm Panel Mount

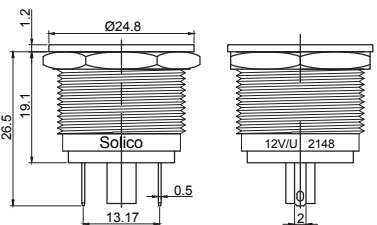
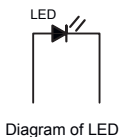
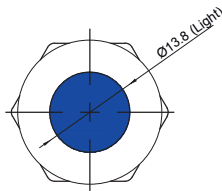

For a sample or quote email Solico at [sales@solico.com](mailto:sales@solico.com) or call us at 860-527-3092.

Sorenson Lighted Controls (Solico) continues its 50+ years history of producing a wide variety of indicator lights and offering value-added services for custom wire length with various connector options, legends, and custom diodes for reverse polarity.



[www.solico.com](http://www.solico.com) | 860-527-3092