

BR Series Metal Indicator Lights

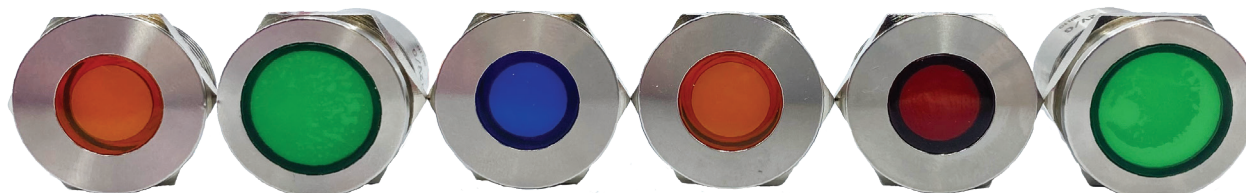

Solico offers a range of BR Series Metal Indicator Lights with 8 / 10 / 12 / 16 / 19 / 22 mm mounting holes, a variety of voltages, LED color options, and fixed or flashing LEDs.



The BR series is designed to offer an aesthetic quality and polished LED light output for a wide range of applications and markets. The threaded bushing indicator includes a hexagon nut and silicone seal to complement its rear epoxy sealed base. The LED is extremely durable due to its solid-state design and ability to withstand a wide temperature range. Solico LED lights reliably indicate the status of different components, reducing the need for maintenance while saving energy in your application.

Features include:

- Threaded Metal Housing
- Imprinted Legends
- Voltage Rating: 5VDC - 110VAC
- Corrosion and Impact Resistant
- IP 67 & IP 68, IK10
- Epoxy Sealed terminations
- Multiple display function
- Dual and Tri color options
- LED's fixed and flashing

BR Series Part Number System

Panel Mounting	Code	Voltage	Code	Termination	Code	Bezel Style	Code	Bezel Finish	Code
08 mm	08	12 VDC	12	Rear Epoxy Wire	1	Flushed	1	Bright Chrome	1
10 mm	10	24 VDC	24	Solder Lug / Fastons (2.8 x 0.8)	5	Recessed	2	Black	2
12 mm	12	125 VAC	15						
16 mm	16								
19 mm	19								
22 mm	22								
Lamp	Code	Lens Colors	Code	Lens Marking	Code	Legend Color	Code	4 Digit Numbering	
Fixed	1	Red	1	Not Applicable	0	Not Applicable	0	None	
		Green	4	Legend Imprint	A	White	1	0.0000 (example)	
Flashing	2	Blue	5			Black	2		
		White	6						
		Yellow	8						

Markets include:

- Transportation
- Emergency Vehicles
- Construction / Agriculture Equipment
- Appliance / Commercial Food
- Vacuums / Floor cleaners
- Vending Machines
- Environmental Controls
- Control Panels
- Factory Automation



BR Series Indicator Light

Spec sheet
8 / 10 / 12 / 16 / 19 / 22 mm

08 mm Panel Mount

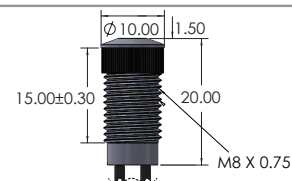
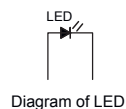
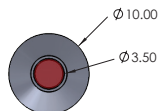

10 mm Panel Mount

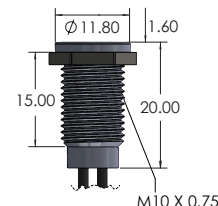
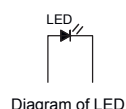
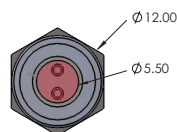

12 mm Panel Mount

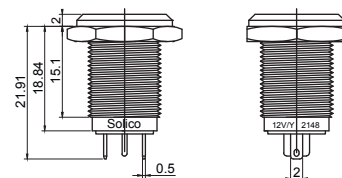
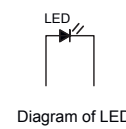
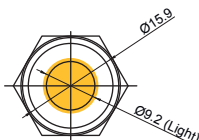
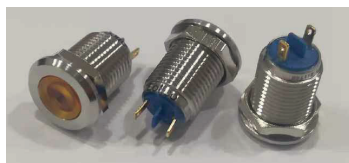

16 mm Panel Mount

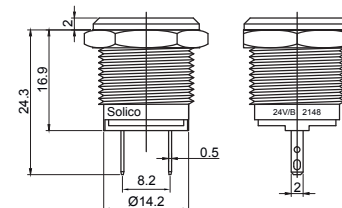
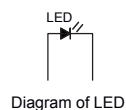
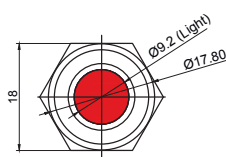
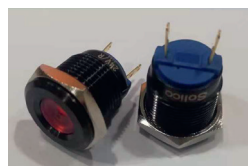

19 mm Panel Mount

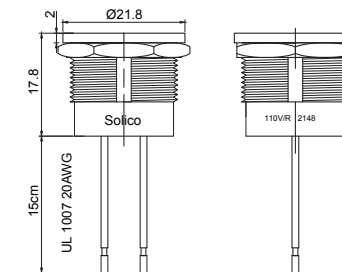
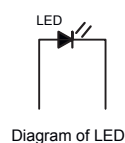
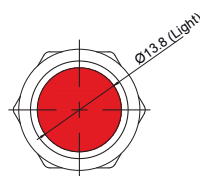

22 mm Panel Mount

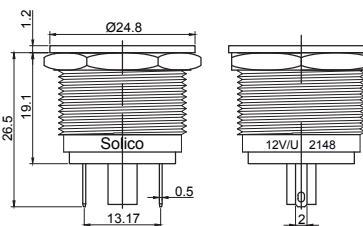
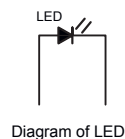
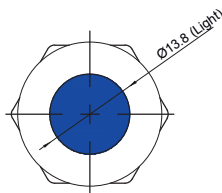

Additional information can be found on our website www.solico.com.

For a sample or quote email Solico at sales@solico.com or call us at 860-527-3092.

Sorenson Lighted Controls (Solico) continues its 50+ years history of producing a wide variety of indicator lights and offering value-added services for custom wire length with various connector options, legends, and custom diodes for reverse polarity.



www.solico.com | 860-527-3092

REV 81623